

Type P according to DIN 69002

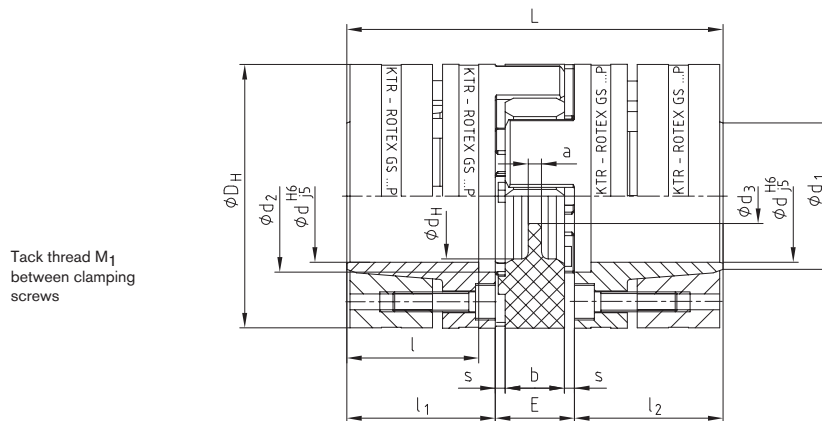

- Backlash-free, highly accurate shaft coupling with integrated clamping system
- Developed specifically for stub spindles on multiple spindle heads according to DIN 69002
- Application on main spindle drives with high speeds, peripheral speeds of 50 m/s and more (please consult with KTR engineering department)
- For high friction torques (consider the selection in case of explosion protection use)
- Easy to assemble due to internal clamping screws
- Approved and certified according to EC Standard 94/9/ EC Certificate ATEX 95)



Tack thread M₁ between clamping screws

ROTEX® GS typeP material of hub/clamping ring steel

| Size | Spider torque T _{KN} [Nm] ¹⁾ | | Dimensions [mm] | | | | | | | | | | Transmittable torque T[R] with Ø d ²⁾ [Nm] | Tightening torque of clamping screws T _A [Nm] | Weight per hub with bore Ø d standard [kg] | Mass moment of inertia with bore Ø d standard [kgm ²] | | | |
|-----------|--|---------|-----------------|------------------------------|----------------|-----|---------------------------------|------|----|----|-----|-----|---|--|--|---|----------------|----------------|------------------------|
| | 98 Sh-A | 64 Sh-D | d ³⁾ | D _H ³⁾ | d _H | L | l ₁ ; l ₂ | l | E | b | s | a | | | | | d ₁ | d ₂ | d ₃ |
| 14 P | 12,5 | 16 | 14* | 32 | 10,5 | 50 | 18,5 | 15,5 | 13 | 10 | 1,5 | 2 | 17 | 17 | 8,5 | 25 | 1,89 | 0,08 | 0,011x10 ⁻³ |
| 19 P 37,5 | 14 | 17 | 16* | 37,5 | 18 | 66 | 25 | 21 | 16 | 12 | 2 | 3 | 20 | 19 | 9,5 | 60 | 3,05 | 0,16 | 0,037x10 ⁻³ |
| 19 P | 21 | 26 | 19* | 40 | 18 | 66 | 25 | 21 | 16 | 12 | 2 | 3 | 23 | 22 | 9,5 | 71 | 3,05 | 0,19 | 0,046x10 ⁻³ |
| 24 P 50 | 43 | 54 | 24* | 50 | 27 | 78 | 30 | 25 | 18 | 14 | 2 | 3 | 28 | 29 | 12,5 | 108 | 4,9 | 0,331 | 0,136x10 ⁻³ |
| 24 P | 60 | 75 | 25* | 55 | 27 | 78 | 30 | 25 | 18 | 14 | 2 | 3 | 30 | 30 | 12,5 | 170 | 8,5 | 0,44 | 0,201x10 ⁻³ |
| 28 P | 160 | 200 | 35* | 65 | 30 | 90 | 35 | 30 | 20 | 15 | 2,5 | 4 | 40 | 40 | 14,5 | 506 | 8,5 | 0,64 | 0,438x10 ⁻³ |
| 38 P | 325 | 405 | 40* | 80 | 38 | 114 | 45 | 40 | 24 | 18 | 3 | 4 | 46 | 46 | 16,5 | 821 | 14 | 1,32 | 1,325x10 ⁻³ |
| 42 P | 450 | 560 | 42 | 95 | 46 | 126 | 50 | 45 | 26 | 20 | 3 | 4 | 52 | 55 | 18,5 | 709 | 35 | 2,23 | 3,003x10 ⁻³ |
| 48 P | 525 | 655 | 45 | 105 | 51 | 140 | 56 | 50 | 28 | 21 | 3,5 | 4 | 52 | 60 | 20,5 | 1340 | 69 | 3,09 | 5,043x10 ⁻³ |
| 55 P | 685 | 825 | 50 | 120 | 60 | 160 | 65 | 58 | 30 | 22 | 4 | 4,5 | 55 | 72 | 22,5 | 1510 | 69 | 4,74 | 10,02x10 ⁻³ |

¹⁾ Further spiders/selection see page 148-151

²⁾ * Standard spindle shaft diameter

³⁾ Ø D_H + 2 mm with high speed for expansion of spider

For the stiffness calculation of the shaft/hollow shaft see KTR standard 45510 on our homepage www.ktr.com

Selection for stub spindles

| Spindle drive | ROTEX® GS P size | Dimensions | | | | |
|---------------|------------------|------------|----------------|---------------------------------|-----|----|
| | | d | D _H | l ₁ ; l ₂ | L | E |
| 25 x 20 | 14 P | 14 | 32 | 18,5 | 50 | 13 |
| 32k x 25 | 19 P37,5 | 16 | 37,5 | 25 | 66 | 16 |
| 32g x 30 | 19 P | 19 | 40 | 25 | 66 | 16 |
| 40 x 35 | 24 P50 | 24 | 50 | 30 | 78 | 18 |
| 50 x 45 | 24 P | 25 | 55 | 30 | 78 | 18 |
| 63 x 55 | 28 P | 35 | 65 | 35 | 90 | 20 |
| 80 x 75 | 38 P | 40 | 80 | 45 | 114 | 24 |

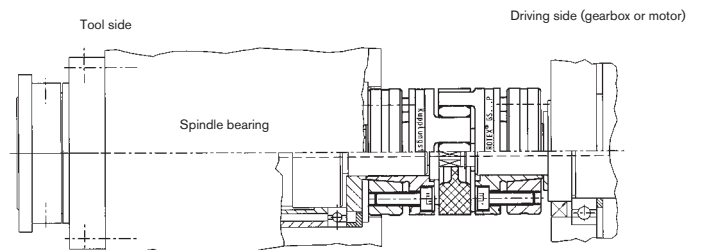

ROTEX® GS type P with central coolant supply for stub spindles and multiple spindle heads

Ordering example:

| ROTEX® GS 24 | P | 98 Sh-A-GS | 6.0 - Ø25 | 6.0 - Ø25 |
|---------------|------|-----------------|------------|-------------|
| Coupling size | Type | Spider hardness | Hub design | Finish bore |
| | | | Hub design | Finish bore |