

MONOLASTIC®

Single-part, flexible flange coupling

Type SAE (EP 0853203/U.S. Patent 6,117,017)

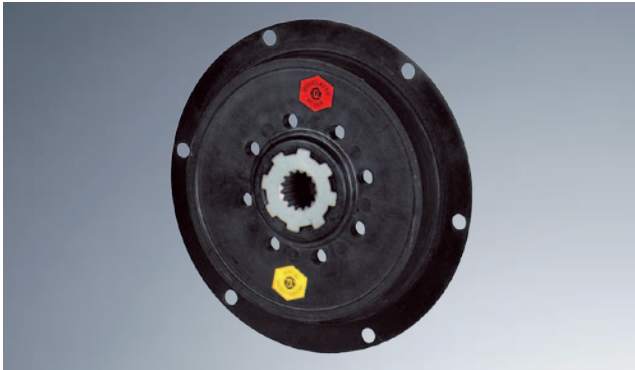

- MONOLASTIC® – for the drive of diesel engine/hydraulic pump up to 100 kW
- Flange connection according to SAE 6 1/2" to 11 1/2"
- Easy assembly of coupling
- Axial plug-in in combination with the pump shaft
- Compensating for high radial and angular displacements
- Available for pump shafts according to SAE and DIN
- Size 65 and 75 also available as an axial plug-in type

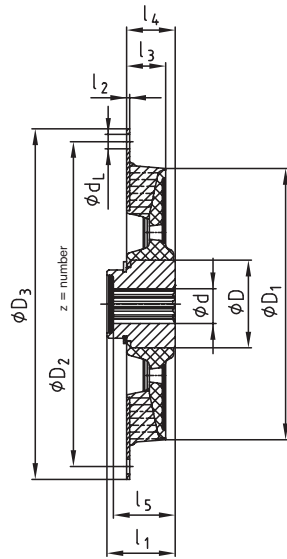

Flange dimensions according SAE J 620 [mm]				
Size	D ₃	D ₂	z	d _L
6 1/2"	215,9	200,02	6	9
7 1/2"	241,3	222,25	8	9
8"	263,52	244,47	6	11
10"	314,32	295,27	8	11
11 1/2"	352,42	333,37	8	11

MONOLASTIC®																		
Size	Elastomer hardness [Shore A]	Torque [Nm]			Dimensions [mm]									MONOLASTIC® flanges according to SAE				
		T _{KN}	T _{K max.}	T _{KW}	d	D	D ₁	l ₁	l ₂	l ₃	l ₄	l ₅	6 1/2"	7 1/2"	8"	10"	11 1/2"	
30	65	160	400	80	25	42	120	39	2	21	30	36	X	X				
	70	200	500	100														
50	65	300	750	150	32	50	167	42	2	24	30	38	X	X	X	X		
	70	400	1000	200														
65	65	600	1500	300	48	68	200	45	3	32	45	42				X	X	
	70	800	2000	400														
75	65	1200	3000	600	60	90	265	58	3	35	50	54				X	X	
	70	1500	3750	750														

Technical data										
Size	Elastomer hardness [Shore A]	C _{dyn.} with 60 °C [Nm/rad]	Perm. damping power with 60 °C P _{KW} [W]	Permissible radial displacement with 2200 rpm ΔK _r [mm]	Perm. angular misalignment with 2200 rpm ΔK _w [°]	Radial spring stiffness C _r [N/mm]	Mass moment of inertia [kgm ²]			Max. permissible operating speed n _{max.} [rpm]
							J _A	J _L	J _T	
30	65	3750	25	0,5	1	1150	6,5"	0,0038	0,00030	6000
	70	4875					7,5"	0,0057		
50	65	9000	35	0,5	1	1300	8"	0,0078	0,00120	6000
	70	12000					10"	0,0153		
65	65	14000	45	0,5	1	1900	10"	0,0238	0,00380	6000
	70	18000					11,5"	0,0368		
75	65	34000	80	0,5	1	1850	10"	0,0272	0,01450	6000
	70	42000					11,5"	0,0402		