

Type S and M with thread for setscrews

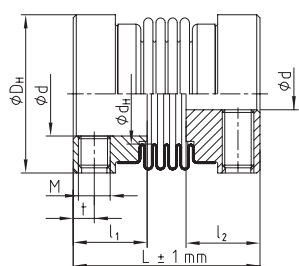

- Backlash-free, torsionally stiff
- Maintenance-free
- Low mass moment of inertia
- Easy assembly due to tolerance F7
- Temperature range for size 5 to 12: -30 °C to +100 °C
Temperature range for size 16 to 20: max. 200 °C
- Finish bore from Ø 6 mm also available with feather key acc. to DIN 6885 sheet 1 – JS9



TOOLFLEX® S Hub design 1.1

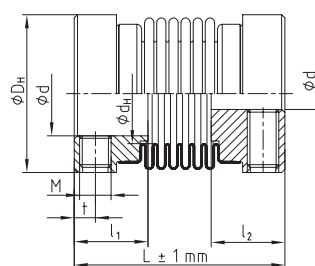

TOOLFLEX® M Hub design 1.1

TOOLFLEX® S/M with thread for set screw (type 1.1) Hub material aluminium/bellow material stainless steel																	
Size	Type ^{1/2)}	Bellow-hub-connection	Bellow torque TKN ³⁾ [Nm]	Dimensions [mm]								Perm. displacements			Torsional stiffness C _T [Nm/rad]	Weight ⁵⁾ [kg]	
				Finish bore		General				Set screw		Axial [mm]	Radial [mm]	Angular [degrees]			
				min. d	max. d	D _H	d _H	L	l ₁ ; l ₂	M	t						number ⁴⁾ z
5	S	Bonded	0,1	2	5	10	6	15 ¹⁾	6	M2	1,8	1	±0,30	0,10	0,7	97	0,0027
	M							17 ²⁾					±0,40	0,15	1,0	75	0,003
7	S		1,0	3	8	15	9	18 ¹⁾	7	M3	2,0	1	±0,30	0,10	0,7	390	0,005
	M							20 ²⁾					±0,40	0,15	1,0	300	0,006
9	S		1,5	3	10	20	12	21 ¹⁾	8	M3	2,2	2	±0,35	0,15	1,0	750	0,010
	M							24 ²⁾					±0,50	0,20	1,5	580	0,011
12	S		2,0	4	14	25	16	27,5 ¹⁾	11	M4	2,8	2	±0,40	0,15	1,0	1270	0,017
	M							31 ²⁾					±0,60	0,20	1,5	980	0,019
16	S	5,0	5	18	32	20	37 ¹⁾	13	M5	4	2	±0,30	0,15	1,0	4500	0,046	
	M						41 ²⁾					±0,50	0,20	1,5	3050	0,049	
20	S	15	6	25	40	27	42 ¹⁾	15	M5	5	2	±0,40	0,15	1,0	9600	0,076	
	M						49 ²⁾					±0,60	0,20	1,5	6600	0,082	

¹⁾ Type S = 4 section bellows

²⁾ Type M = 6 section bellows

³⁾ For selection see page 168

⁴⁾ Quantity each hub, from size 9: 2x120° offset

⁵⁾ Figures refer to the complete coupling with max. bores

Circumferential speed v_{max} = 20 m/s

Hub design 1.1 = hub without keyway with thread for set screws.

Hub design 1.0 = hub with keyway with thread for set screws.

Ordering example:	TOOLFLEX® 7 M		1.1 - Ø4		1.1 - Ø6	
	Coupling size	Hub design	Finish bore	Hub design	Finish bore	